

F30/F40 Screen Mount

Specifications

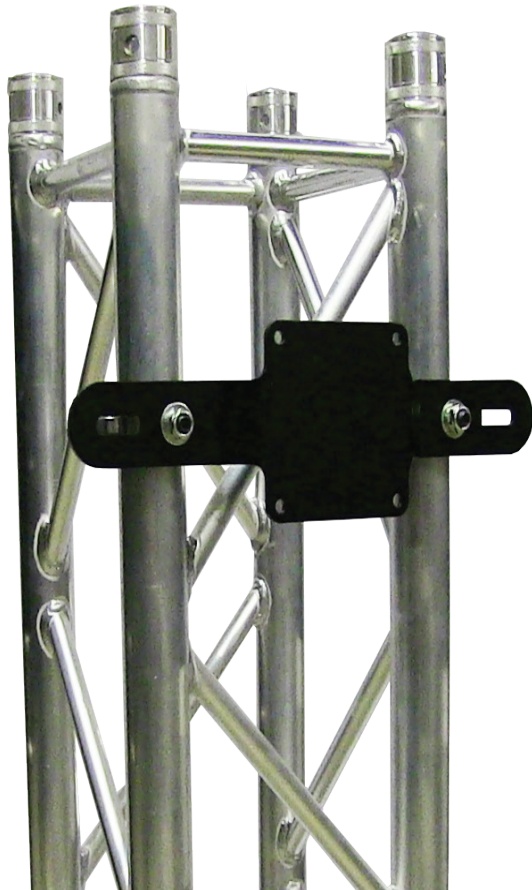

The F30/F40 Screen Mount from Cosmic Truss has been designed as a low profile, smart bracket for mounting monitors or TV's to any truss from the F31 thru F34 or F42 thru F44 series.

Constructed from steel, the bracket is sturdy and extremely strong ensuring a solid mount for any piece of equipment. The bracket measures 16 inches wide, is just 3/16 inch thick, and weighs just 4 lbs., keeping it lightweight and easily portable. It ships complete with two Cosmic Truss narrow half couplers and so is ready for use straight out of the box.

With universally compatible VESA mounting holes, the bracket will accept any standard VESA television or presentation monitor effortlessly and forms a much more compact solution than other mounting systems on the market.

Further mounting adaptors in the Cosmic Truss range are available for larger format screens that don't use the VESA mounting system.

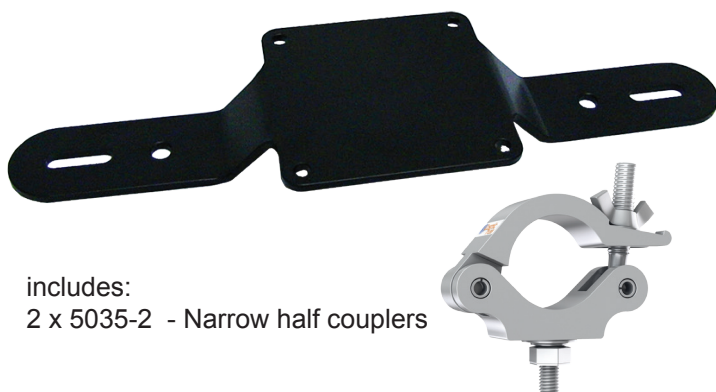

includes:
2 x 5035-2 - Narrow half couplers

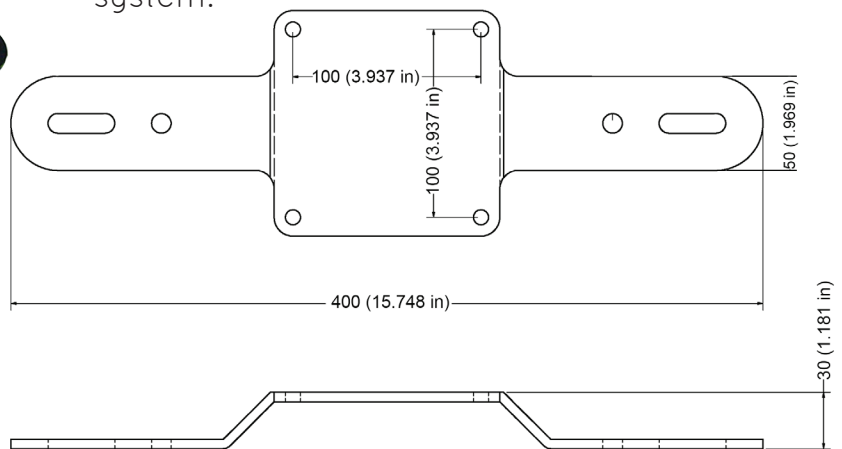

Contact your Cosmic Truss dealer or visit www.cosmictruss.com for more details.